



*Fitzgeralds*

# Woodlands

HOUSE HOTEL  
 HEALTH & LEISURE SPA



## Conference Facilities

Capacity	Treaty 300 Suite
Theatre	80
Boardroom	30
Classroom	35
U Shape	50
Round Tables	50
Capacity	Fitzgerald Suite
Theatre	400
Boardroom	75
Classroom	150
U Shape	100
Round Tables	150
Capacity	Laccabawn Suite
Theatre	100
Boardroom	40
Classroom	70
U Shape	45
Round Tables	60
Capacity	Cocktail Bar
Theatre	40
Boardroom	28
Classroom	30
U Shape	16
Round Tables	24
Capacity	Mountwilliam Suite
Theatre	30
Boardroom	20
Classroom	20
U Shape	15
Round Tables	20

Adare,  
 Co. Limerick, Ireland.

Tel: Int. +353 61 605100  
 Fax: Int. +353 61 396073  
 E-mail: [reception@woodlands-hotel.ie](mailto:reception@woodlands-hotel.ie)  
 Web: [www.woodlands-hotel.ie](http://www.woodlands-hotel.ie)



*Fitzgeralds*  
**Woodlands**  
 HOUSE HOTEL  
 HEALTH & LEISURE SPA

Fitzgerald Suite

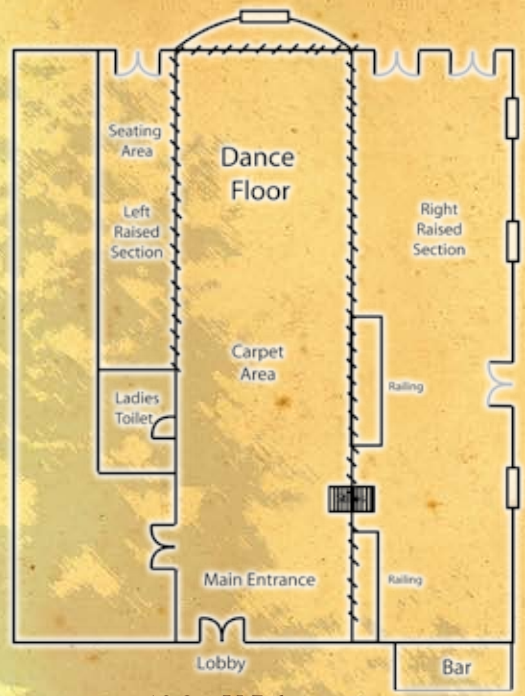

19.8m X 7.6m

Laccabawn Suite

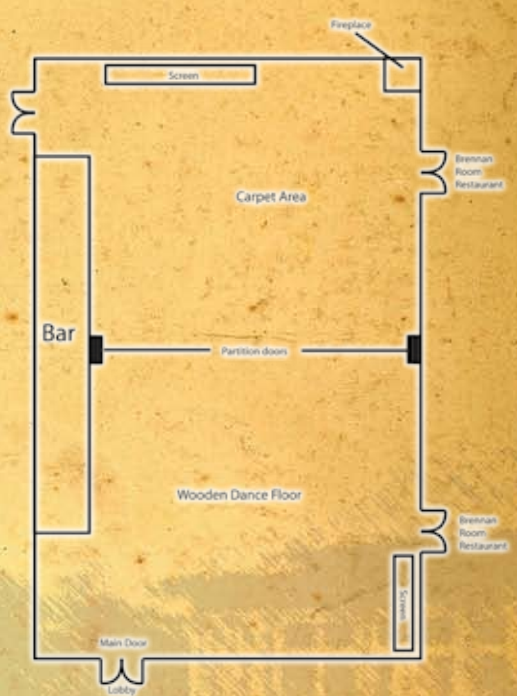

11.5m X 10.5m

Treaty 300 Suite  
 Bay Window

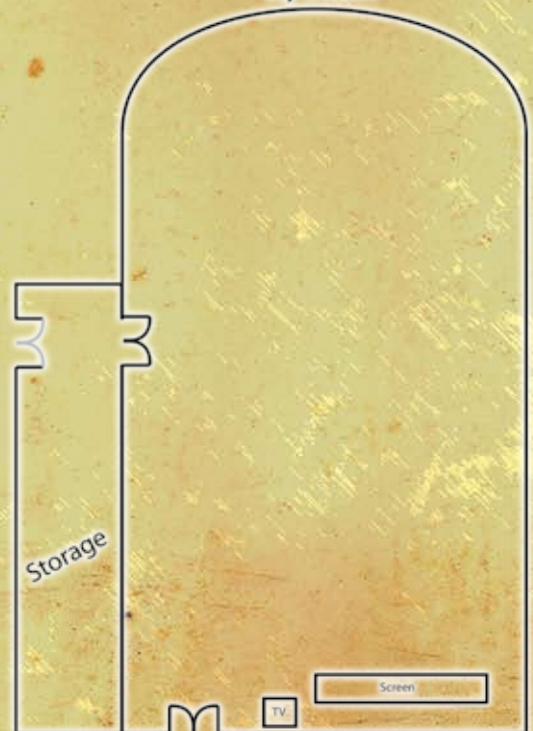

11m X 8m

-  Emergency Exit
-  Standard Door
-  Raised Area
-  Window